

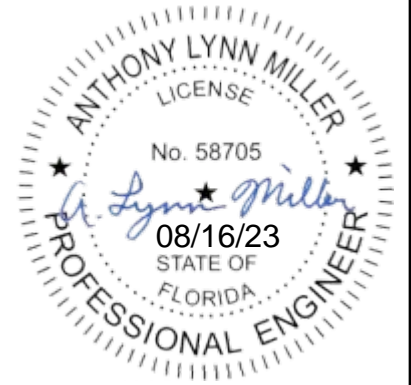

SERIES 8000, MODEL 8550 (XX)
HORIZONTAL ROLLER WINDOW,
IMPACT RESISTANT,
EQUAL-LEG FRAME

DP RATING	LARGE & SMALL MISSILE IMPACT RESISTANT
+50/-60 PSF	



A. LYNN MILLER, P.E., P.E.# 58705

- 1) THIS PRODUCT HAS BEEN DESIGNED & TESTED TO COMPLY WITH THE REQUIREMENTS OF THE FLORIDA BUILDING CODE, EXCLUDING THE HIGH VELOCITY HURRICANE ZONE (HVHZ).
- 2) SHUTTERS ARE NOT REQUIRED WHEN USED IN WIND-BORNE DEBRIS REGIONS.
- 3) MASONRY ANCHORS MAY BE USED INTO WOOD. ALL WOOD BUCKS LESS THAN 1-1/2" THICK ARE TO BE CONSIDERED 1X INSTALLATIONS. 1X WOOD BUCKS ARE OPTIONAL IF UNIT IS INSTALLED DIRECTLY TO SUBSTRATE. WOOD BUCKS DEPICTED AS 2X ARE 1-1/2" THICK OR GREATER.
- 4) ANCHOR EMBEDMENT TO BASE MATERIAL SHALL BE BEYOND WALL DRESSING OR STUCCO. USE ANCHORS OF SUFFICIENT LENGTH.
- 5) MAX. 1/4" SHIMS ARE REQUIRED AT EACH ANCHOR LOCATION WHERE THE PRODUCT IS NOT FLUSH TO THE SUBSTRATE. USE SHIMS CAPABLE OF TRANSFERRING APPLIED LOADS.
- 6) THE ANCHORAGE METHODS SHOWN HAVE BEEN DESIGNED TO RESIST THE WIND LOADS CORRESPONDING TO THE REQUIRED DESIGN PRESSURE. THE 33-1/3% STRESS INCREASE HAS NOT BEEN USED IN THE DESIGN OF THIS PRODUCT. THE 1.6 LOAD DURATION FACTOR WAS USED FOR THE EVALUATION OF ANCHORS INTO WOOD. ANCHORS THAT COME INTO CONTACT WITH OTHER DISSIMILAR MATERIALS SHALL MEET THE REQUIREMENTS OF THE FLORIDA BUILDING CODE FOR CORROSION RESISTANCE.

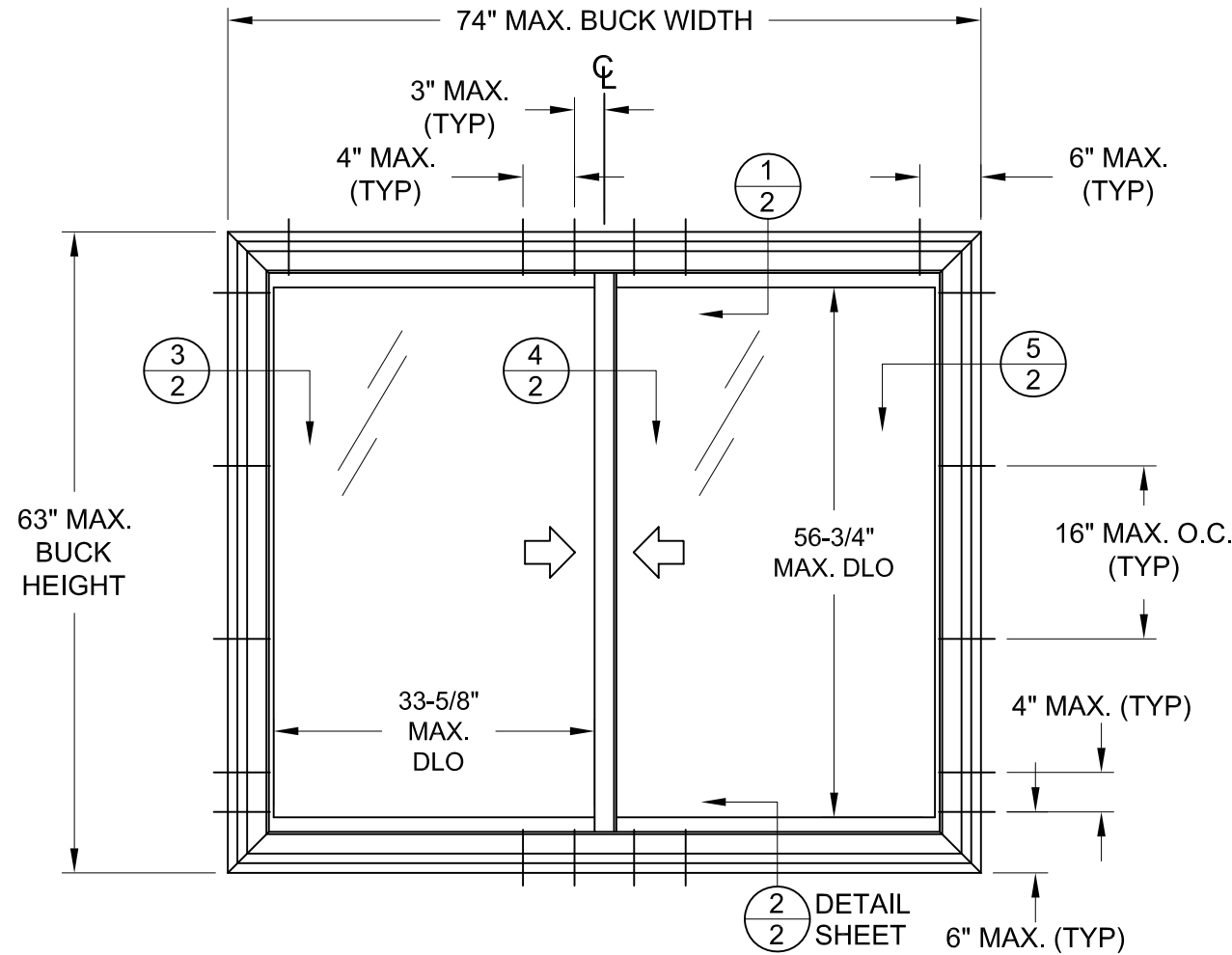

TYP. ANCHOR LOCATIONS
(XX CONFIGURATION)

TABLE 1: DESIGN PRESSURES

Buck Width	Buck Height	Configuration	Design Pressure	
			(+) psf	(-) psf
74"	63"	XX	50.0	60.0

- 1) FOR SIZES NOT SHOWN, ROUND UP TO THE NEXT AVAILABLE WIDTH OR HEIGHT DIMENSION.
- 2) FOR GLASS DESCRIPTIONS, SEE SHEET 4.
- 3) BUCK DIMENSIONS SHOWN.

REGISTRATION #29296
 PREPARED BY: A. LYNN MILLER, P.E.
 1070 TECHNOLOGY DR
 N. VENICE, FL 34275
 (941)-480-1600

COPYRIGHT © 2021
 NEWSOUTH WINDOW SOLUTIONS
 LIMITED LICENSE TO MAKE
 COPIES FOR PERMITTING

8000 SERIES HORIZ. ROLLER
 MODEL 8550, LMI
 GENERAL NOTES, XX DESIGN PRESSURES
 & ANCHOR ELEVATION
 NEWSOUTH WINDOW SOLUTIONS
 10741 CROSSROADS COMMERCE BLVD.
 TAMPA, FL 33610

BY:	SB
REVISION:	CORRECT SERIES # IN TITLE BLOCK, ADD 995 SILICONE
DATE:	8/16/23
#:	1

DATE: 12/16/2022
 SCALE: NTS
 BY: LOGAN YODER
 DRAWING #: HR8000-FPA-LM
 SHEET: 1 OF 4

TABLE 2: INSTALLATION ANCHORS

Anchor	Substrate	Minimum Edge Distance	Minimum Embedment
#10 or #12 Steel or 410 SS Screw	Southern Pine (SG = .55)	9/16"	1"
	Aluminum, 6063-T5 min.	5/16"	0.045 (18 Ga)
	Steel Stud, Gr. 33 min.	5/16"	0.035" (20 Ga)
	A36 Steel	5/16"	0.035" (20 Ga)
3/16" Steel Ultracon+	Concrete (min. 2.9 ksi)	1"	1-3/8"
	UngROUTED CMU, (ASTM C-90)	1"	1-1/4"
	Southern Pine (SG = .55)	1/2"	1"
1/4" Steel Ultracon+	Concrete (min. 3.0 ksi)	1"	1"
	UngROUTED CMU, (ASTM C-90)	1"	1-1/4"
	Southern Pine (SG = .55)	1"	1"

INSTALLATION NOTES:

- 1) SEE SHEET 1 FOR ANCHOR SPACING REQUIREMENTS.
- 2) ANY INSTALLATION OPTION SHOWN (2X BUCK OR WOOD FRAMING, 1X BUCK, DIRECT TO MASONRY, STEEL STUD) MAY BE USED ON ANY SIDE OF THE WINDOW.
- 3) USE ONLY SUBSTRATE APPROPRIATE ANCHORS LISTED IN ANCHOR TABLE 2. FOLLOW EMBEDMENT AND EDGE DISTANCE LIMITS. MAXIMUM SHIM THICKNESS TO BE 1/4".

- 1) ANCHOR MUST EXTEND A MINIMUM OF 3 THREADS BEYOND ANY METAL SUBSTRATE.
- 2) "UNGROUTED CMU" VALUES MAY BE USED FOR GROUTED CMU APPLICATIONS.
- 3) ALL ANCHOR HEAD TYPES ARE APPLICABLE.

NOTE:

- 1) ITEM #12, ANTI-LIFT BLOCKS ARE 32" LONG @ HEAD. SEE ANTI-LIFT BLOCK ATTACHMENT DETAIL BELOW.

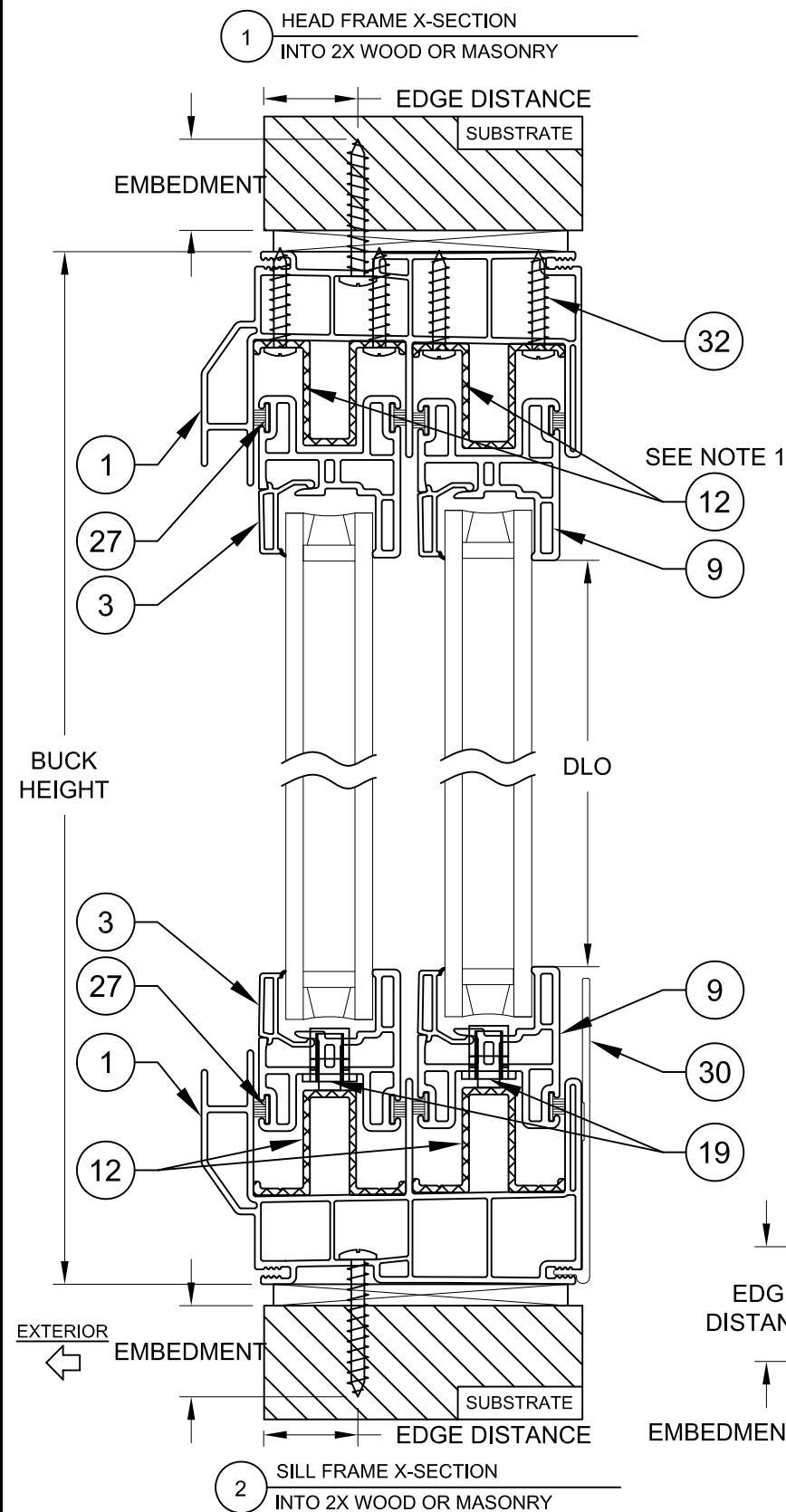

SEE NOTE 1

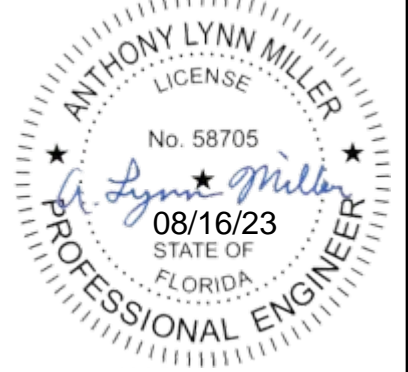
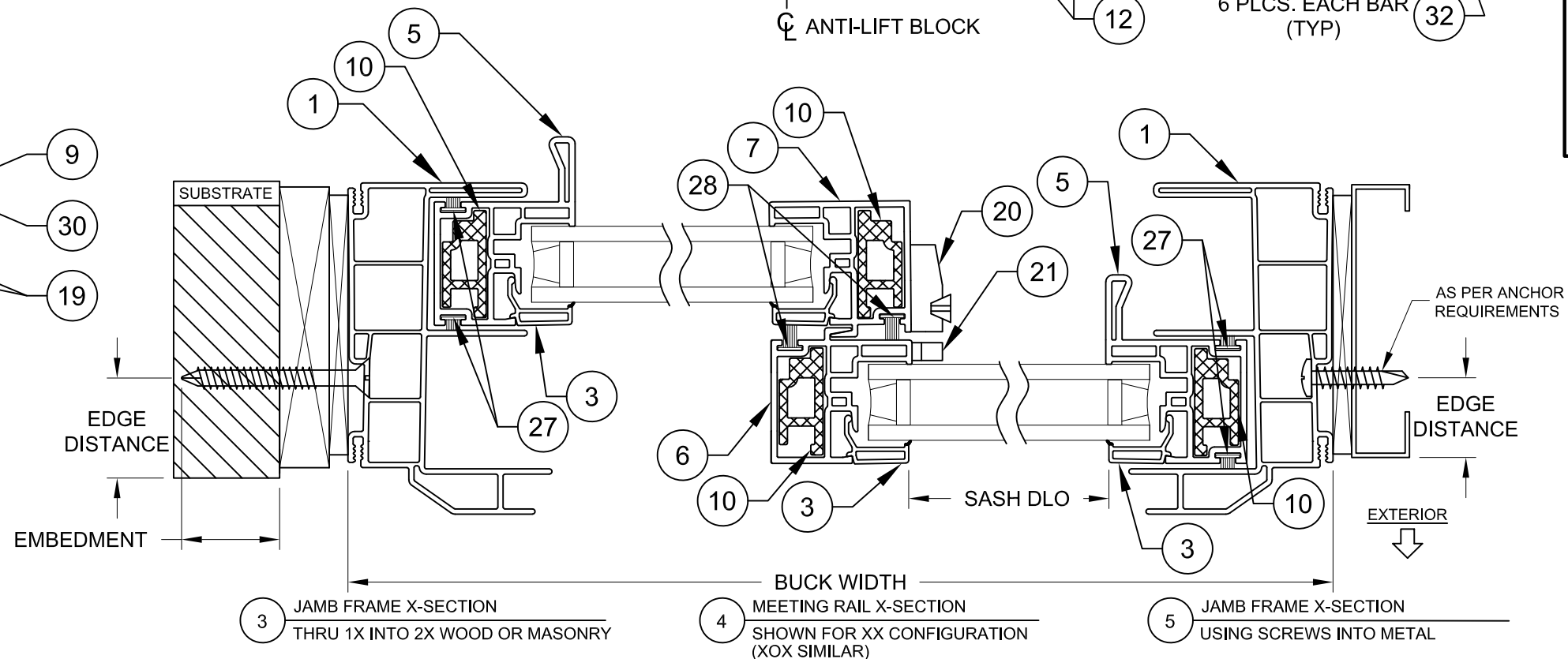
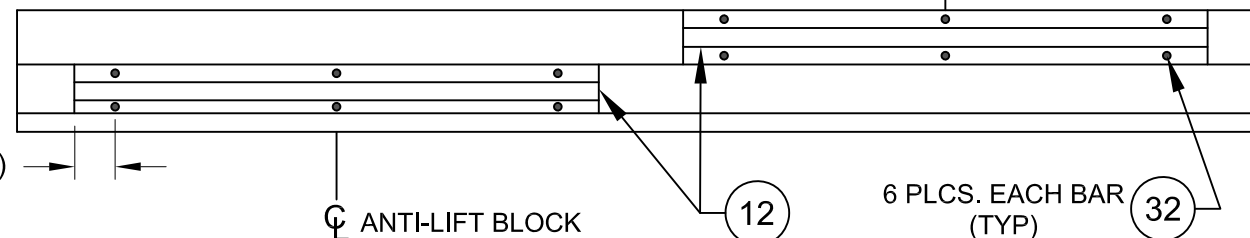

A. LYNN MILLER, P.E., P.E.# 58705

REGISTRATION #29296

COPYRIGHT © 2021
NEWSOUTH WINDOW SOLUTIONS
LIMITED LICENSE TO MAKE
COPIES FOR PERMITTING

PREPARED BY: A. LYNN MILLER, P.E.

1070 TECHNOLOGY DR
N. VENICE, FL 34275
(941)-480-1600

8000 SERIES HORIZ. ROLLER
MODEL 8550, LMI

INSTALLATION & ANCHOR TYPES

NEWSOUTH WINDOW SOLUTIONS
10741 CROSSROADS COMMERCE BLVD.
TAMPA, FL 33610

BY: SB

REVISION:
CORRECT SERIES # IN TITLE
BLOCK, ADD 995 SILICONE

DATE: 8/16/23

#: 1

DATE: 12/16/2022

SCALE: NTS

BY: LOGAN YODER

DRAWING #: HR8000-FPA-LM

SHEET: 2 OF 4

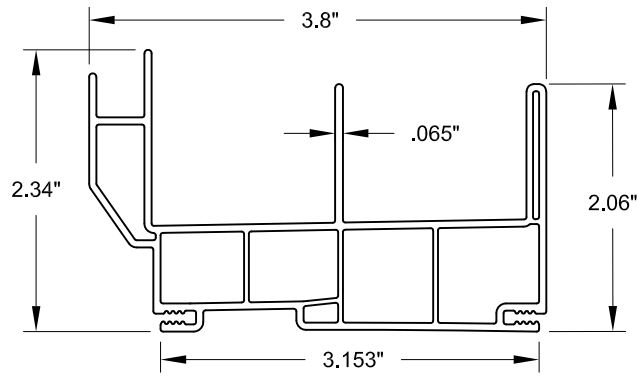

1 FRAME

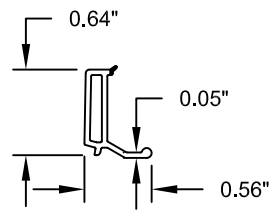

3 GLAZING BEAD

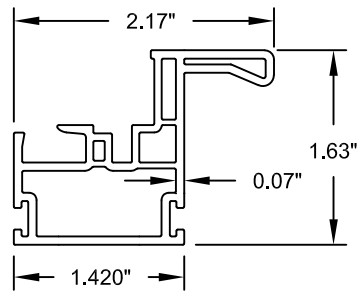

5 HANDLE STILE

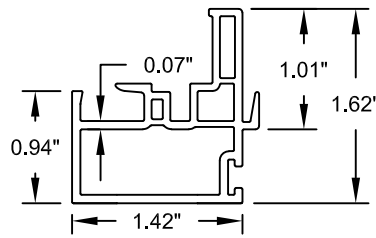

6 KEEPER STILE

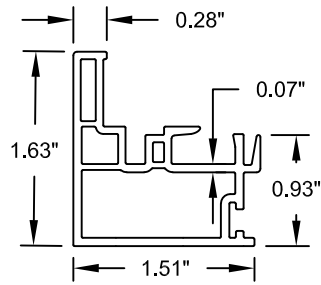

7 LOCK STILE

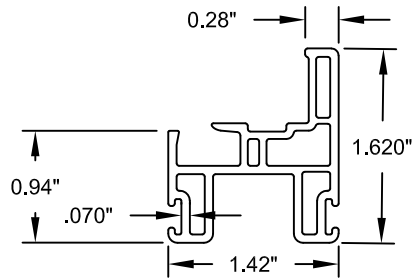

9 RAIL

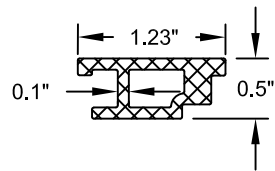

10 REINFORCEMENT

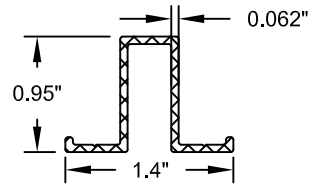

12 ANTI-LIFT BLOCKS

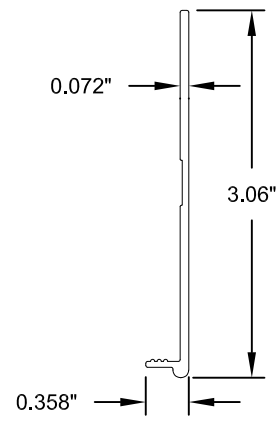

30 SILL RISER

TABLE 3:

BILL OF MATERIALS			
ITEM #	PART #	DESCRIPTION	MATERIAL
1	444F QC	Frame	Rigid PVC
3	425A QC	Glazing Bead	Rigid PVC
5	F-9475	Handle Stile	Rigid PVC
6	F-9493	Keeper Stile	Rigid PVC
7	F-9494	Lock Stile	Rigid PVC
9	F-9478	Rail	Rigid PVC
10	H-2641	Reinforcement	6065-T5
12	S-6162	Anti-Lift Blocks	6065-T5
19		Sash Rollers	-
20		Lock	-
21		Keeper	-
27		Weatherstrip (0.250" Single Fin Pile)	-
28		Weatherstrip (0.350" Single Fin Pile)	-
30	6536	Sill Riser	6065-T5
31		RGS7700, Sika 552, Dow 791/983/995 Backbedding	Silicone
32		#8 X 1" PPH SMS	
33		Insulated Glass Spacer	

THE APPROVED, RIGID PVC EXTERIOR EXTRUSIONS ARE TO BE PRODUCED BY EXTRUDERS' LICENSEES UNDER "AAMA CERTIFICATION PROGRAMS FOR RIGID PVC EXTRUSIONS".

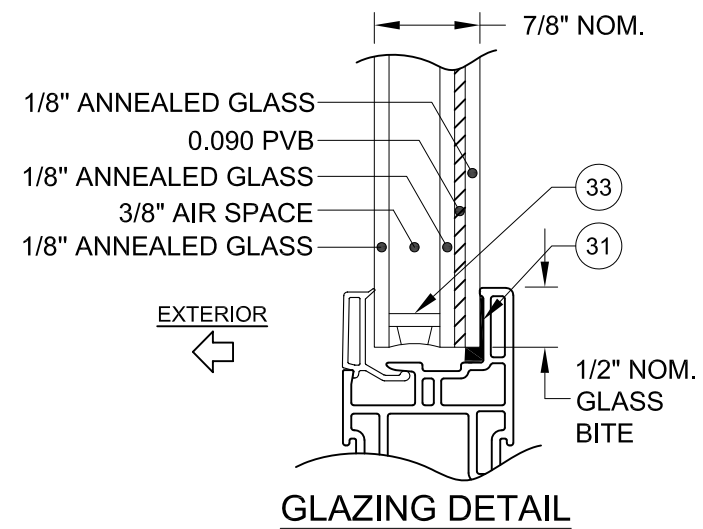

GLAZING DETAIL



A. LYNN MILLER, P.E., P.E.# 58705

REGISTRATION #29296

COPYRIGHT © 2021
NEWSOUTH WINDOW SOLUTIONS
LIMITED LICENSE TO MAKE
COPIES FOR PERMITTING

8000 SERIES HORIZ. ROLLER
MODEL 8550, LMI

EXTRUSIONS, BOM, & GLAZING DETAIL

NEWSOUTH WINDOW SOLUTIONS
10741 CROSSROADS COMMERCE BLVD.
TAMPA, FL 33610

PREPARED BY: A. LYNN MILLER, P.E.

1070 TECHNOLOGY DR
N. VENICE, FL 34275
(941)-480-1600

BY:	SB
REVISION:	CORRECT SERIES # IN TITLE BLOCK, ADD 995 SILICONE
DATE:	8/16/23
#:	1
DATE:	12/16/2022
SCALE:	NTS
BY:	LOGAN YODER
DRAWING #:	HR8000-FPA-LM
SHEET:	3 OF 4

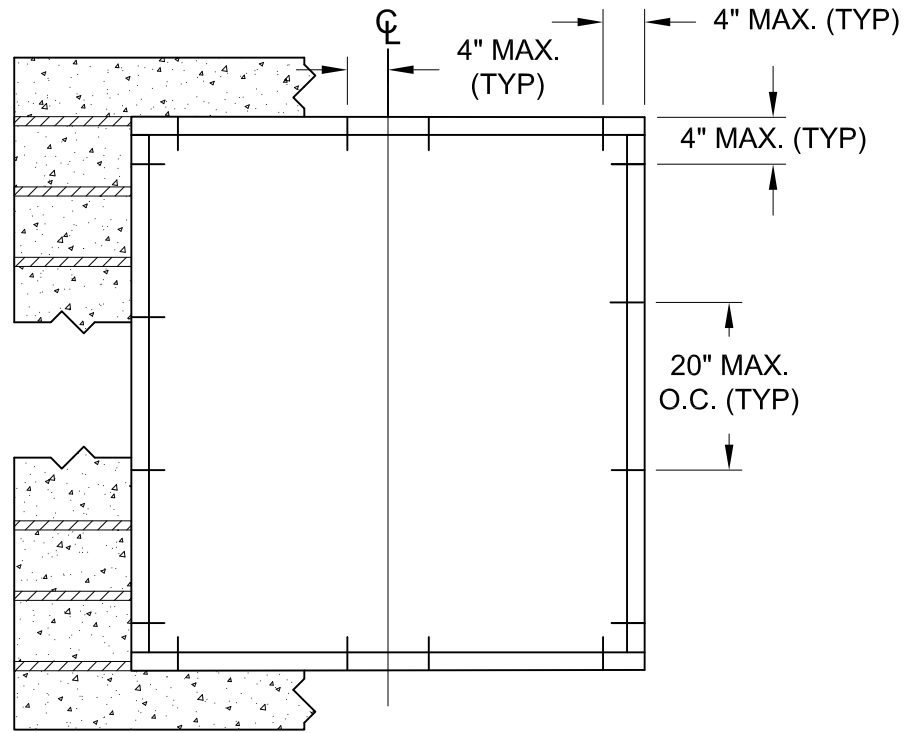

BUCK ANCHORAGE DETAIL

TABLE 4:

Anchor	Substrate	Minimum Edge Distance	Minimum Embedment
1/4" Steel Ultracon+	Concrete (min. 3.0 ksi)	1"	1-3/8"
	UngROUTED CMU, (ASTM C-90)	1"	1-1/4"

- 1) "UNGROUTED CMU" VALUES MAY BE USED FOR GROUTED CMU APPLICATIONS.
- 2) ALL ANCHOR HEAD TYPES ARE APPLICABLE.



A. LYNN MILLER, P.E., P.E.# 58705

PREPARED BY: A. LYNN MILLER, P.E. 1070 TECHNOLOGY DR N. VENICE, FL 34275 (941)-480-1600	REGISTRATION #29296 COPYRIGHT © 2021 NEWSOUTH WINDOW SOLUTIONS LIMITED LICENSE TO MAKE COPIES FOR PERMITTING	8000 SERIES HORIZ. ROLLER MODEL 8550, LMI WOOD BUCK INSTALLATION NEWSOUTH WINDOW SOLUTIONS 10741 CROSSROADS COMMERCE BLVD. TAMPA, FL 33610	<table border="1" style="width: 100%; border-collapse: collapse;"> <tr> <td style="width: 15%;">REVISION:</td> <td style="width: 15%;">CORRECT SERIES # IN TITLE BLOCK, ADD 995 SILICONE</td> <td style="width: 15%;">DATE:</td> <td style="width: 15%;">8/16/23</td> <td style="width: 15%;">#:</td> <td style="width: 15%;">1</td> </tr> <tr> <td>BY:</td> <td>SB</td> <td colspan="4"></td> </tr> </table> <p>DATE: 12/16/2022</p> <p>SCALE: NTS</p> <p>BY: LOGAN YODER</p> <p>DRAWING # : HR8000-FPA-LM</p> <p>SHEET: 4 OF 4</p>	REVISION:	CORRECT SERIES # IN TITLE BLOCK, ADD 995 SILICONE	DATE:	8/16/23	#:	1	BY:	SB				
REVISION:	CORRECT SERIES # IN TITLE BLOCK, ADD 995 SILICONE	DATE:	8/16/23	#:	1										
BY:	SB														